

Dear participant,

Here is some useful information you may want to consult before coming to Istanbul.

- 1- Note that Galatasaray University is at **Ortaköy**, a district of Istanbul riparian to the Bosphorus (so that there is no confusion with the Galatasaray Lycée which is near Taksim, people tend to be misled).
- 2- The conference rooms will be fully equipped for presentations.
- 3- Photocopies may be done at the photocopy center of the university at the participant's expense.
- 4- Computers will be available in the computer room of the university's library (internet use available).
- 5- WIFI is available at the cafeteria and in the library.
- 6- Those who wish to have lunch at the University Restaurant will be asked to pay 20 YTL (10 YTL per lunch) at the registration desk. The payment will be in cash and in YTL. YTLs can be obtained from ATM cash machines (there is also one in the university). Note that you will not be getting a receipt for the lunch tickets, because the supplier asks to be paid the whole amount.
- 7- Late registration and/or membership payments may be done in cash at the registration desk.
- 8- The hotels suggested on the website are fully booked. We further suggest two hotels situated around Taksim Square:
  - SED Hotel single-45 euros, double-60 euros, <http://www.sedhotel.com/home.html>
  - SAVOY Hotel single-65 euros, double 80 euros, <http://www.savoy.com.tr/>The rates include breakfast and VAT; do mention that you are coming for the conference held at the Galatasaray University in order to benefit from the negotiated rates.
- 9- For any urgent matter you may contact Ayça Akarçay : +90-535 569 65 37 for international calls, 0535 569 65 37 for local calls.
- 10- Below is a map of the university, indicating session rooms and other useful points. There will be a coffee corner throughout the conference at the Auditorium Hall; alongside with the bookstands and the registration desk.
- 11- In order to access to the buildings on the upper side of the Çırağan cad. you first need to enter from the main entrance on the lower side (Bosphorus side) then pass through the underground tunnel. Anyhow, you will be guided by indications.

Looking forward to seeing you in Istanbul.

Best regards.

Organization Committee for the EAEPE Conference 2006

eaepe2006@gmail.com

<http://eaepe.gsu.edu.tr>

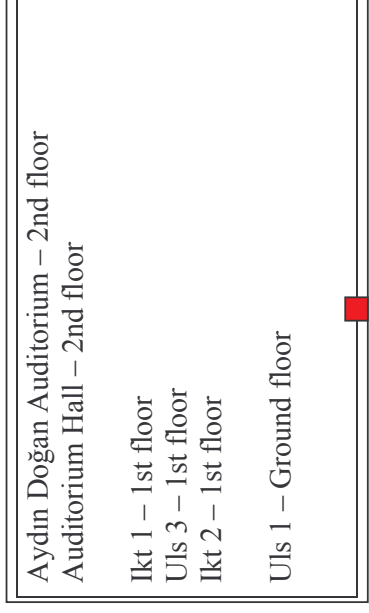
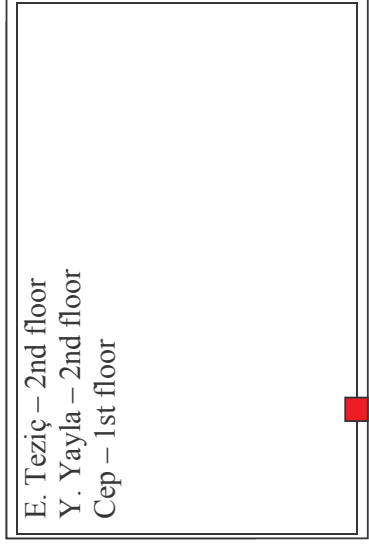

← TO BEŞİKTAŞ

BUS STOP

ÇIRAĞAN CAD. (AVENUE)

TO ORTAKÖY →

BUS STOP

UNIVERSITY  
ENTRANCE

Şükrü Sarı –  
Ground floor

UNDERGROUND  
TUNNEL



YL 1  
YL 2  
Photocopy center

S  
T  
A  
I  
R  
S

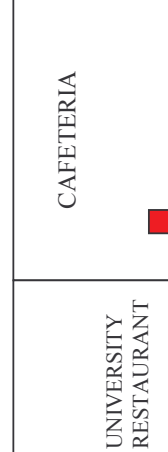

S  
T  
A  
I  
R  
S

